



1.1.20

ARCO 490



Lismarca





### UTILIZZI - USE - USO

SISTEMA PER TENDE ARRICCIATE INDICATO PER AMBIENTI DOMESTICI E PROFESSIONALI MEDIO /GRANDI

- Azionamento con corde
- Indicato per tendaggi L 1000 cm max ed H 500 cm di peso non superiore a 12 kg.
- L'apertura può essere centrale, laterale, multipla o asimmetrica
- Il sistema è indicato per installazioni a soffitto ed a parete
- Lo scorrimento delle corde d'azionamento in canali indipendenti paralleli permette la realizzazione di sistemi curvi a 90° o centinati ad ampio raggio, garantendo un'ottima scorrevolezza.
- Per lo scorrimento il sistema utilizza:  
scivoli in polietilene (6 kg max per 6 m - 490/1)  
scorrevoli a rullo (12 kg max per 6 m - 490/2).

DRAPED CURTAIN SYSTEM FOR MEDIUM /LARGE DOMESTIC AND PROFESSIONAL ENVIRONMENTS

- Cord operated
- For use with curtains 1000 cm W max. and 500 cm H not weighing more than 12 kg.
- The opening can be central, lateral, multiple or asymmetric
- The system is suitable for ceiling and wall installations
- The running of the operating cords in independent channels allows systems with 90° curves or with wide radius curving to be installed, guaranteeing excellent sliding.
- The system uses the following for sliding:  
polyethylene slides (6 kg max. for 6 m - 490/1)  
roller gliders (12 kg max. for 6 m - 490/2).

SISTEMA PARA CORTINAS ENCRESPADAS ADECUADO PARA AMBIENTES DOMÉSTICOS Y PROFESIONALES MEDIO /GRANDES

- Accionamiento mediante cuerdas
- Adecuado para cortinas de anchura máx. 1000 cm y H 500 cm, con peso no superior a 12 kg.
- La apertura puede ser central, lateral, múltiple o asimétrica
- Este sistema es indicado para montajes en techo o en pared
- El deslizamiento de las cuerdas de accionamiento en canales independientes permite realizar instalaciones curvas en 90° o cimbreadas de radio amplio, garantizando una óptima deslizabilidad.
- Para el deslizamiento el sistema utiliza:  
deslizaderas de polietileno (máx. 6 kg para 6 m - 490/1)  
deslizaderas de rodillo (máx. 12 kg para 6 m - 490/2).

### PORTATA TENDE - CURTAIN WEIGHT - PESO CORTINAS

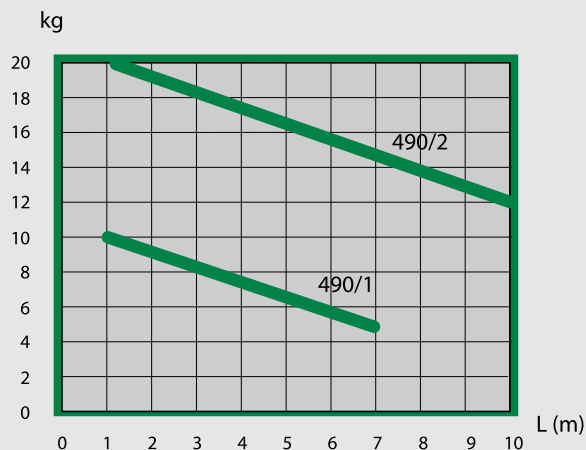

### CARATTERISTICHE - DESCRIPTION CARACTERÍSTICAS

1:1

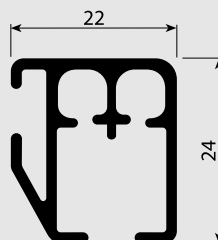

- Profilo in lega d'alluminio estrusa 6060 T6 UNI 8278
- Larghezza 22 mm - Altezza 24 mm
- Canale di scorrimento: 6 mm
- Raggio di curvatura minima curve a 90°: 12 cm  
curve ad ampio raggio: 50 cm
- Finiture superficiali  
verniciatura poliester bianco RAL 9016  
verniciatura poliester nero RAL 9005  
anodizzato argento - oro - bronzo
- Carrucole in termoplastico antiurto con ruote su perni in acciaio
- Sormonto in acetilica autolubrificante con asta in acciaio sino a 10 cm
- Accessori in acetilica autolubrificante

- 6060 T6 UNI 8278 extruded aluminium alloy track
- Width 22 mm - Height 24 mm
- Sliding channel: 6 mm
- Minimum radius of curvature 90° curves: 12 cm  
wide radius curves: 50 cm
- Surface finishes  
RAL 9016 white polyester paint; RAL 9005 black polyester paint  
silver - gold - bronze anodised
- Shockproof thermoplastic pulleys with wheels on steel journals
- Self-lubricating acetylic overlap with steel rod up to 10 cm
- Self-lubricating acetylic accessories

- Perfil en aleación de aluminio extruida 6060 T6 UNI 8278
- Anchura 22 mm - Altura 24 mm - Canal de deslizamiento: 6 mm
- Radio de curvatura mínima  
curvas en 90°: 12 cm; curvas de radio amplio: 50 cm
- Acabado de las superficies pintura poliéster blanca RAL 9016;  
pintura poliéster negra RAL 9005; anodizado plata - oro - bronce
- Garruchas de termoplástico antigolpe con ruedas sobre pernos de acero
- Sobreposición de acetálico autolubrificante con asta de acero de hasta 10 cm
- Accesorios de acetálico autolubrificante

APERTURA - OPENING - APERTURA

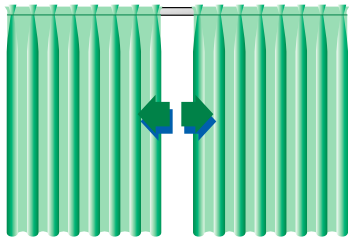

- Centrale
- Central
- Central

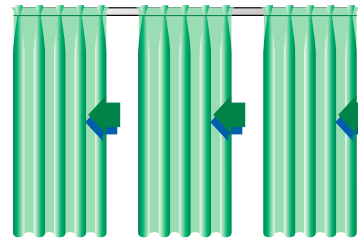

- Multipla
- Multiple
- Multiple

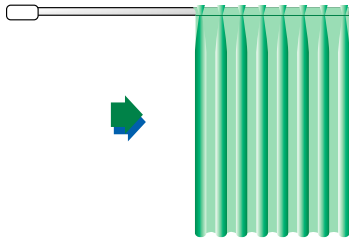

- Laterale
- Lateral
- Lateral

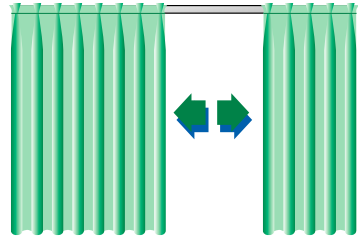

- Asimmetrica
- Asymmetric
- Asimetrica

INSTALLAZIONE - INSTALLATION - INSTALACIÓN

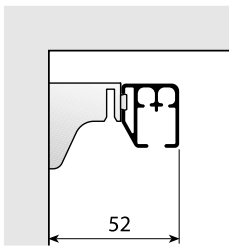

4083

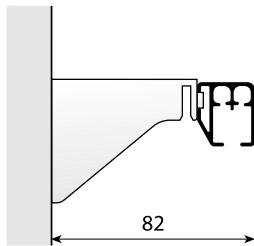

4084

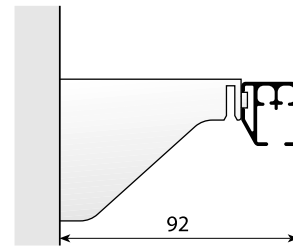

4085

A parete  
Wall mounting  
A pared

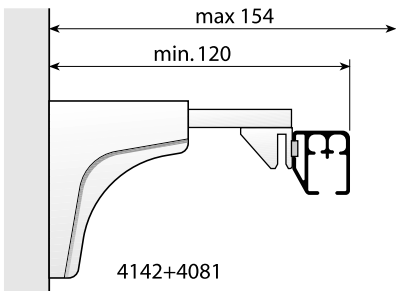

4142+4081

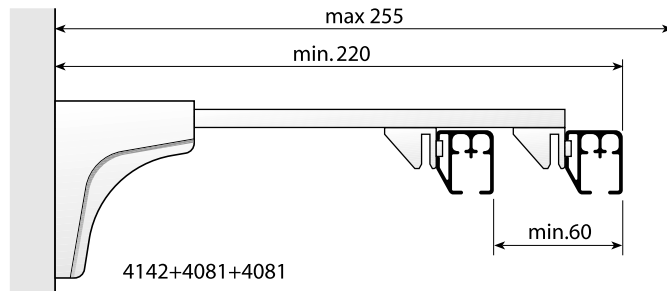

4142+4081+4081

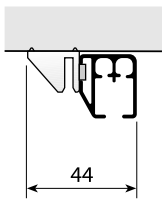

4081

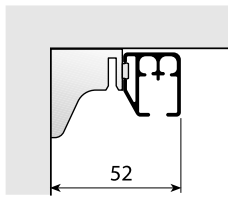

4083

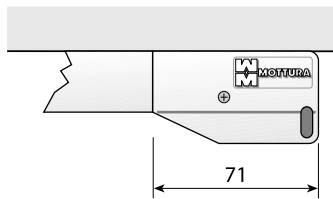

4340

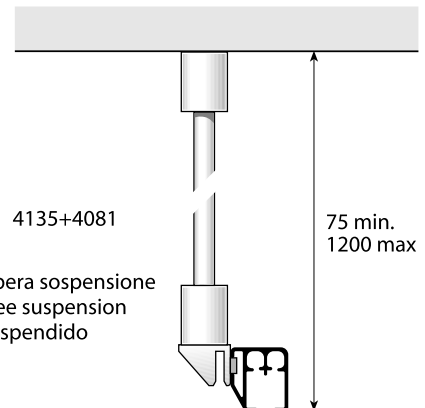

4135+4081

75 min.  
1200 max

A soffitto  
Ceiling mounting  
A techo

Libera sospensione  
Free suspension  
Suspendido

### CURVE - BENDING - CURVAS

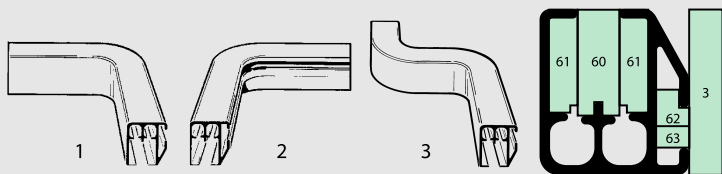

- Si possono realizzare curve a 90° interne (1), esterne (2) ed miste (3) con il set di dime 9868 e le curvatrici 9801/2.
- With the insert-set 9868 and the bending machines 9801/2 it is possible to make 90° internal (1), external (2), mixed (3) curves.
- Pueden realizarse curvas de 90° grados, internas (1), externas (2) y mixtas (3) con el conjunto de policarbonatos ref. 9868 utilizables en las máquinas curvadoras ref. 9801/2.

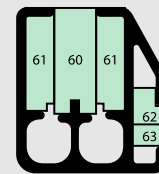

- Si possono realizzare curve ad ampio raggio con il set di dime 9869 e la centinatrice 9805.
- Large radius curves are possible with the insert-set 9869 and the bending machine 9805.
- Pueden realizarse curvas de amplio radio con los policarbonatos 9869 y la máquina curvadora 9805.

### CONFEZIONI CONSIGLIATE - SUGGESTED STYLES OF CURTAINS TIPOS DE CONFECCIÓN

← →		nastro - tape - cinta
	1:2	art. 761 - h 70 mm art. 775 - h 65 mm art. 776 - h 80 mm art. 777 - h 100 mm
	1:1,5	art. 773 - h 90 mm art. 387
	1:2	art. 773 - h 90 mm art. 387
	1:2	art. 761 - h 70 mm art. 776 - h 80 mm art. 777 - h 100 mm
	1:2	art. 761 - h 70 mm art. 776 - h 80 mm art. 777 - h 100 mm
	1:3	art. 780 - h 90 mm art. 773 - h 90 mm art. 387
	1:3	art. 773 - h 90 mm art. 387

← →  
INDICA IL RAPPORTO DI ARRICCIATURA  
IT SHOWS THE SPACE BETWEEN THE PLEATS  
RAPPORT DE FRUNCIDO

### CARRUCOLA INTERMEDIA - INTERMEDIATE RETURN PULLEY POLEA INTERMEDIA

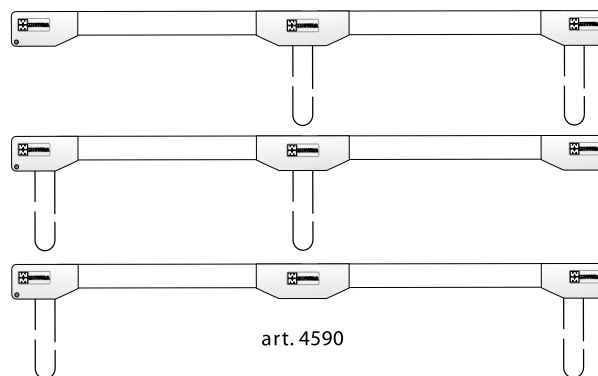

### SORMONTO - OVERLAP - CRUCE

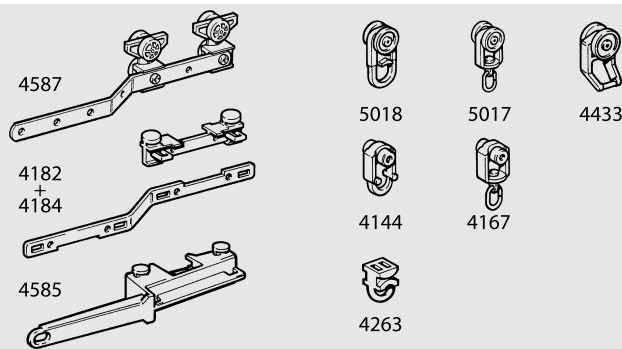

### SCIVOLI - GLIDERS - CORREDERAS

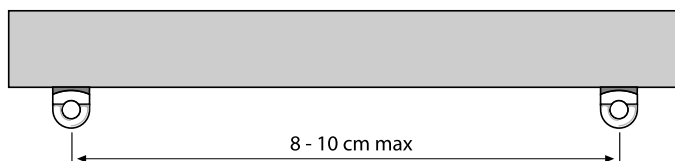

### POSIZIONAMENTO SUPPORTI - SUPPORT POSITIONING DISTANCIA ENTRE SOPORTES

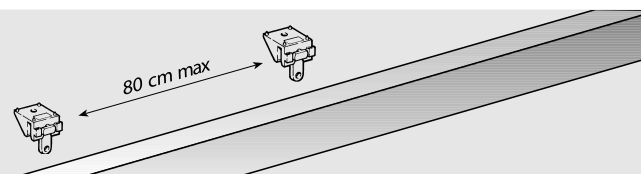





1.1.24

# ARCO 490

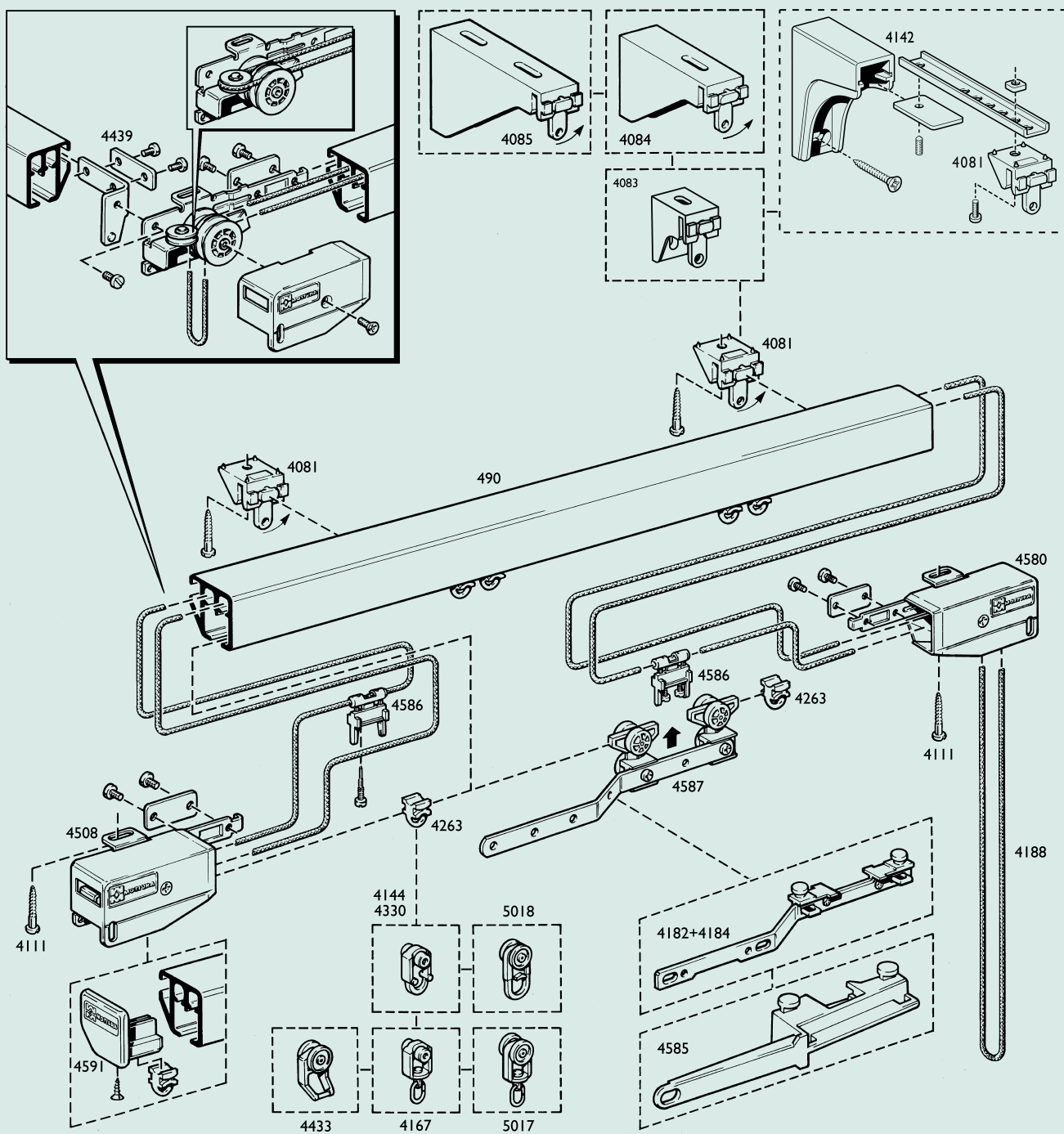

## SISTEMAZIONE - APPLICATION - COLOCACIÓN

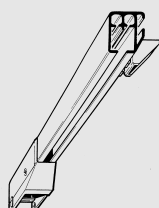

Dritto  
Straight  
Recto

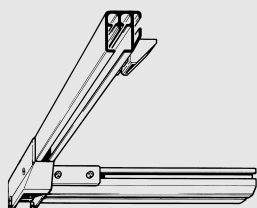

Angolo retto con carrucola  
Right angle with pulley  
Angulo recto con polea

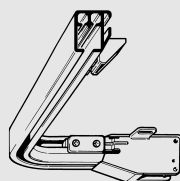

Curva a 90°  
90° curve  
Curvado 90°

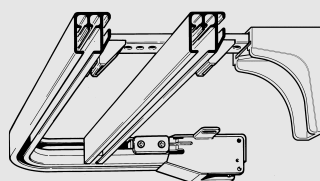

Curva a 90° + dritto  
90° curve + straight  
Curvado 90° + recto

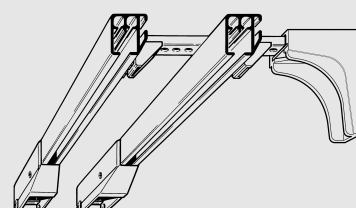

Dritti in parallelo  
Twin straight tracks  
Recto y paralelo