



Lismarca

Decorações, Hotelaria e Similares

Sistema de Guias **TYPE R** ST-CR

| SISTEMAS DE SOMBREAMENTO





PRODUCT DESCRIPTION

VERTICAL MODEL

The type R guided vertical roller blinds are recommended for window sizes up to 500 x 300/300 x 500 cm (indoors). Manual or motorised operation is available:

Manual system with crank (models ACGR35/ACGR42/ACGR70):

Gear box with ratio 1:2.8 (ACGR35, ACGR42) complete with endstop to determine the exact final position of the blind (up/down) or ratio 1:5 (ACGR70). Ø 13 mm aluminium crank rod (anodised silver or black) with PVC coated folding handle. Optional accessories: 90° through wall coupling ; bayonet fitting.

Motorised system 230 V/50 Hz (models MCGR40/MCGR50/MCGR506/MCGR507): **CE**

Single phase tubular motor Ø 37 (MCGR40) and Ø47, 230V/50Hz complete with endstop and mains cable. Thermal cutout to prevent overheating and water tight housing with level IP44 protection. The motor is operated by a two-pole switch (not supplied). Optional accessories: remote control with/without incorporated receiver, electronic board for multilevel centralised operation, sun/wind control unit.

Roller tube: in extruded aluminium (Ø 35, Ø 42, Ø 43/47, Ø 53/57 & Ø 60) or galvanized steel (Ø 70 & Ø 78), with slot for easy dismounting & remounting of the fabric.

Box: mod. **CT76/C83/C103/CT103/CV140/C150** in aluminium, composed of a fixed part and a removable cover for easy maintenance of the blind. Box complete with plastic or aluminium lateral checks. The choice of the box depends upon blind dimensions.

Side channels: mod. **G80** in extruded aluminium with brush strip, complete with brass wall clips for face mounting; alternatively lateral mounting is possible.

Bottom rail: mod. **FG42**, in extruded aluminium, dim.12x42 mm, complete with plastic end caps. Extruded aluminium extra weighting bar mod. **FG42R** for blind widths over 400 cm.

Fabric: a wide range of technical shading and blackout fabrics, with class 1 fire retardant certification. Galvanised steel, Ø 4,5 mm reinforcement rods inserted in horizontal welded pockets in the fabric, normally approximately 60-90 cm apart.

HORIZONTAL MODEL

TYPE R horizontal blinds are designed for slanted windows or skylights of dimensions up to 200 x 400 cm. The horizontal blind is supplied ready mounted on an "L" shaped frame that facilitates installation; the blind is only suitable for indoor applications; manual (crank) or motorised versions are available.



Manual system with crank (models OACGR42/OACGR70):

Gear box with ratio 1:2.8 (OACGR42) complete with endstop to determine the exact final position of the blind (up/down) or ratio 1:5 (OACGR70). Ø 13 mm aluminium crank rod (anodised silver or black) with bayonet fitting and PVC coated folding handle.



Motorised system 230 V/50 Hz (models OMCGR40/OMCGR50/OMCGR507): C €

Single phase tubular motor Ø 37 (OMCGR40) and Ø 47, 230V/50Hz complete with endstop and mains cable. Thermal cutout to prevent overheating and water tight housing with level IP44 protection. The motor is operated by a two-pole switch (not supplied). Optional accessories: remote control with/without incorporated receiver, electronic board for multilevel centralised operation.

Motorised system T.T.S.(models OMCGR7TS): C €

Two tubular motors Ø50, 230V/50Hz TTS HiPro with control unit and 2,5 m mains cable. Thermal cutout to prevent overheating (8 min) and water tight housing with level IP44 protection. Optional accessories: remote control with/without incorporated receiver, electronic board for multilevel centralised operation.



Driver roller tube: in extruded aluminium (Ø 42, Ø 43/47, Ø 53/57) or galvanised steel (Ø 78), into which the crank or motor is inserted: in the T.T.S. version the tube contains one of the motors with grooved Teflon pulleys onto which the high tension steel cables are wound.

Opposite roller tube: in extruded aluminium (Ø 30) or galvanised steel (Ø 43, Ø 70, Ø 78) onto which the fabric is wound and containing a steel harmonic loaded spring or, in the T.T.S. version, the second motor with Teflon adapters.

Double box: mod. C83/C103/CT103/CV140/C150 in extruded aluminium composed of a fixed part and a removable cover for easy maintenance of the blind. Box complete with plastic or aluminium lateral cheeks.

Side channels: mod. G80 in extruded aluminium with brush strip. The channels have two functions: to guide the fabric during operation and to hide the drag belts attached to the bottom rail and the driver tube. The blind is supplied with the side channels already mounted on an "L" shaped frame that is then fixed to the box end cheeks during installation.

Bottom rail: mod. FG42, in extruded aluminium, dim.12x42 mm, complete with plastic end caps. Extruded aluminium extra weighting bar model FG42R for blind widths over 150 cm.

Fabric: a wide range of technical shading and blackout fabrics for indoor applications, with class 1 fire retardant certification. Galvanised steel, Ø 4,5 mm reinforcement rods inserted in horizontal welded pockets in the fabric, approximately 60-90 cm apart.

TECHNICAL DATA

MODEL	ACGR35 ACGR42	ACGR70	MCGB40	MCGR50 MCGR506	MCGB507	OACGR42	OACGR70	OMCGR40	OMCGR50	OMCGR507	OMCGR7TS
VERSION	VERTICAL					HORIZONTAL					
OPERATION	CRANK		MOTOR			CRANK		MOTOR			TTS MOTOR
ROLLER TUBE	Ø35 - Ø42	Ø70	Ø43 - Ø47	Ø53 - Ø57	Ø78	Ø42	Ø70	Ø43/47	Ø53/57	Ø78	Ø78
NOMINAL COUPLE (MIN)	-	-	5 Nm	10 Nm	10 Nm	-	-	5 Nm	10 Nm	10 Nm	25 Nm
OPERATING SPEED	1:2.8	1:5	6 cm/s	6 cm/s	8 cm/s	1:2.8	1:5	6 cm/s	5 cm/s	8 cm/s	8 cm/s
MAX LIFTING WEIGHT	6 Kg	15 Kg	25 Kg	32 Kg	26 Kg	6 Kg	15 Kg	25 Kg	32 Kg	26 Kg	65 Kg
VOLTAGE	-	-	230V 50Hz			-	-	230V 50Hz			
ABSORBED POWER	-	-	115 W	120 W	120 W	-	-	115 W	120 W	120 W	170 W
CE MARKING	-	-	CEI 60335-2-97			-	-	CEI 60335-2-97			
INSTALLATION SHEET	SP-010, SP-017, SP-201		SP-010, SP-007, SP-201			SP-010 SP-005					SP-010SP-006
USERS & MAINTENANCE MANUAL	-	-	MT-001			-	-	MT-002			
MIN DIMENSIONS WxH (cm)	50 x 50	50 x 50	80 x 50	80 x 50	80 x 50	50 x 60	50 x 50	40 x 60	80 x 80	80 x 80	80 x 80
MAX DIMENSIONS WxH (cm)	300 x 320	400 x 320	250 x 250	350 x 400	500 x 300 300 x 500	160 x 250	200 x 350	160 x 250	200 x 250	200 x 350	200 x 400

EXAMPLE OF TYPE R GUIDED SYSTEM MODELS ACGR70 / MCGR507

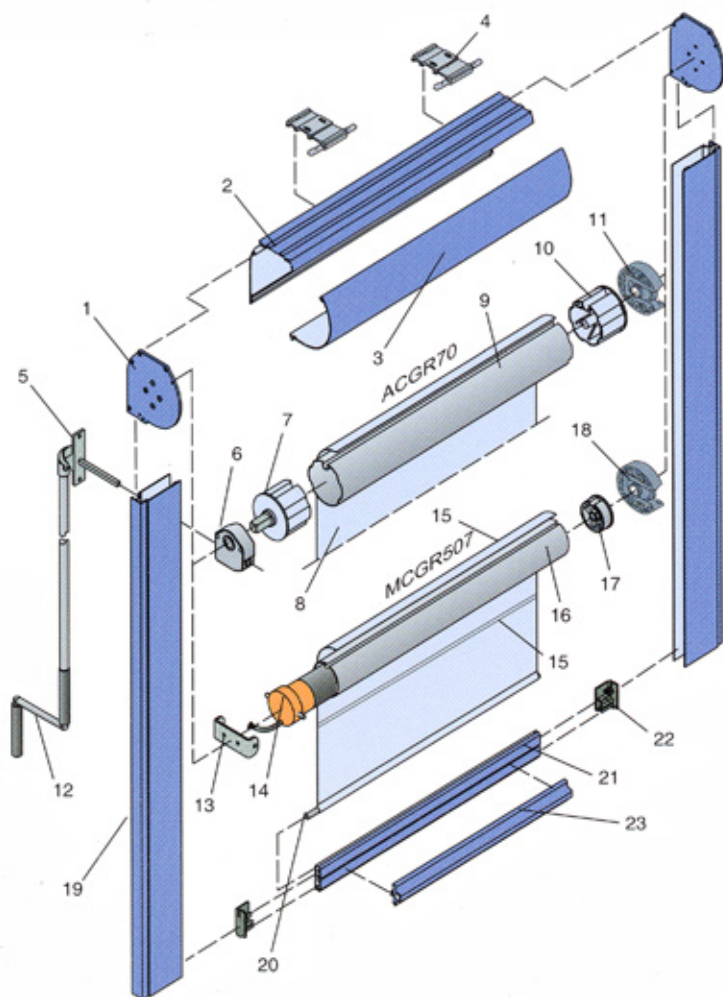

- 1 END CHEEKS
- 2 BOX CT103 FIXED PART
- 3 BOX CT103 REMOVABLE COVER
- 4 CEILING BRACKETS
- 5 THROUGH WALL COUPLING 90°
- 6 GEAR BOX RATIO 1:5
- 7 END PLUG
- 8 FABRIC
- 9 ROLLER TUBE Ø 70
- 10 OPPOSITE SIDE END PLUG
- 11 PLASTIC BRACKET
- 12 CRANK ROD AND HANDLE
- 13 MOTOR BRACKET
- 14 TUBULAR MOTOR
- 15 REINFORCEMENT ROD Ø 4,5 mm
- 16 ROLLER TUBE Ø 78
- 17 OPPOSITE SIDE END PLUG
- 18 PLASTIC BRACKET
- 19 SIDE CHANNELS G80
- 20 PLASTIC ROD
- 21 BOTTOM RAIL FG42
- 22 END CAPS FOR BOTTOM RAIL
- 23 WEIGHTING BAR FG42R

Exploded views of the other system models are available upon request from our technical office.

EXAMPLE OF TYPE R HORIZONTAL SYSTEM MODELS OACGR42 - OMCGR40

- 1 BOX C83 REMOVABLE COVER.
- 2 BOX C83 FIXED PART
- 3 ALUMINIUM END CHEEKS
- 4 BRACKET FOR END PLUG
- 5 SPRING ASSEMBLY
- 6 ROLLER TUBE Ø 43
- 7 END PLUG
- 8 INSERT
- 9 "L" FRAME 25x40
- 10 SIDE CHANNELS G80
- 11 END CAPS FOR BOTTOM RAIL
- 12 FABRIC
- 13 REINFORCEMENT ROD Ø 4,5 mm
- 14 BOTTOM RAIL FG42
- 15 BRUSH STRIP
- 16 DRAG BELT
- 17 MOTOR BRACKET
- 18 TUBULAR MOTOR M40
- 19 ROLLER TUBE Ø 43/47
- 20 OPPOSITE SIDE END PLUG
- 21 BEARING
- 22 GEAR BOX RATIO 1:2.8
- 23 END PLUG
- 24 ROLLER TUBE Ø 42
- 25 END STOP
- 26 CRANK ROD AND HANDLE
- 27 BAYONET FITTING

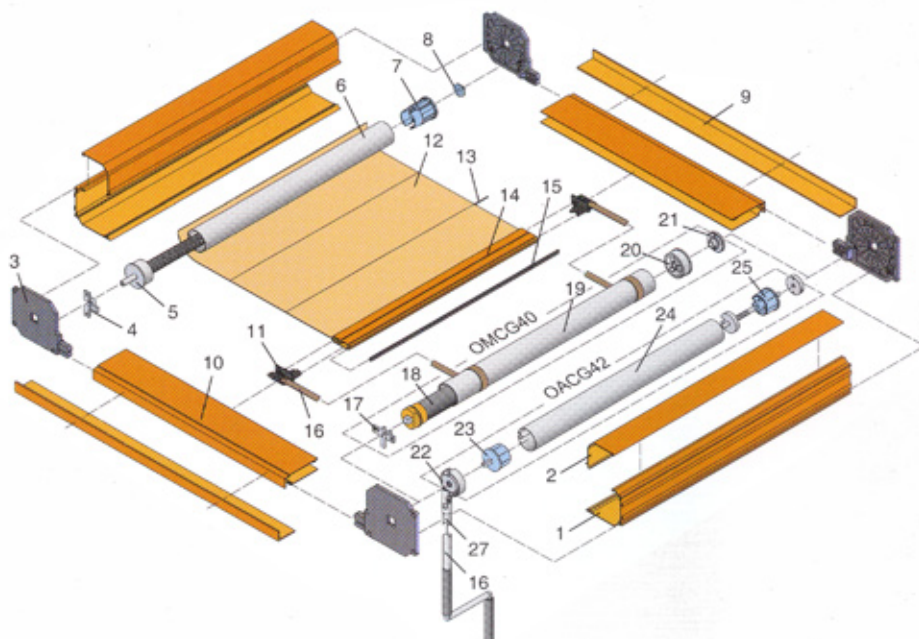

FRAME

ALUMINIUM FRAME

Frame is in extruded aluminium alloy Al 6060 T5. Standard colours available: white, anodised silver, black & bronze. Powder coated RAL colours are available upon request.

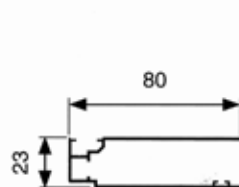

G80

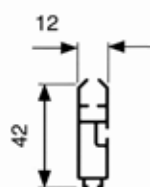

FG42

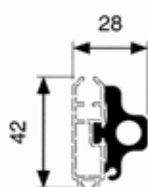

FG42R

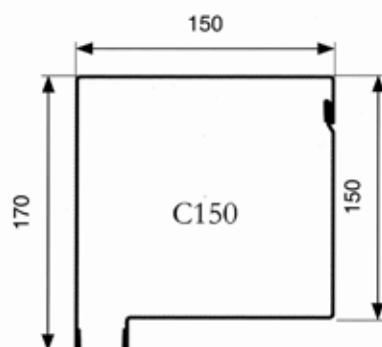

C150

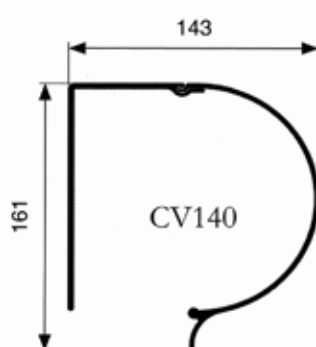

CV140

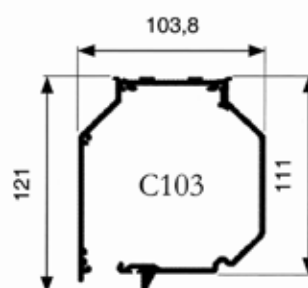

C103

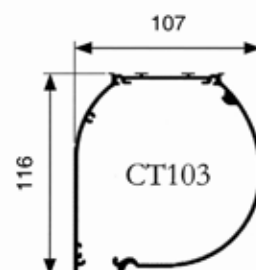

CT103

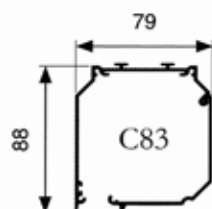

C83

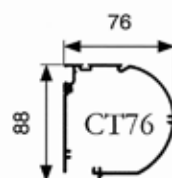

CT76

BOX	CT76	C83	C103/CT103	CV140	C150
MAX WIDTH VERTICAL BLIND (cm)	220	330	500	500	400
MAX WIDTH HORIZONTAL BLIND (cm)	160	160	200	200	200
INSTALLATION SHEET	SP-104	SP-101	SP-105	SP-107	SP-106

OVERALL DIMENSIONS

VERTICAL MODEL

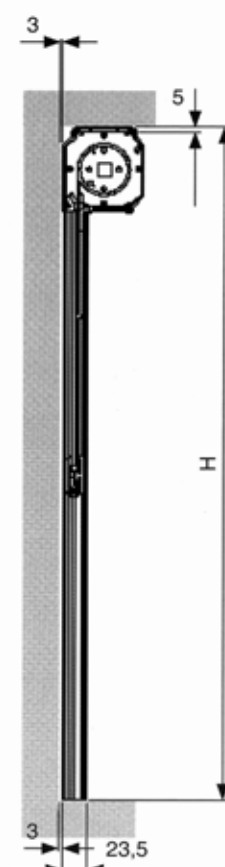
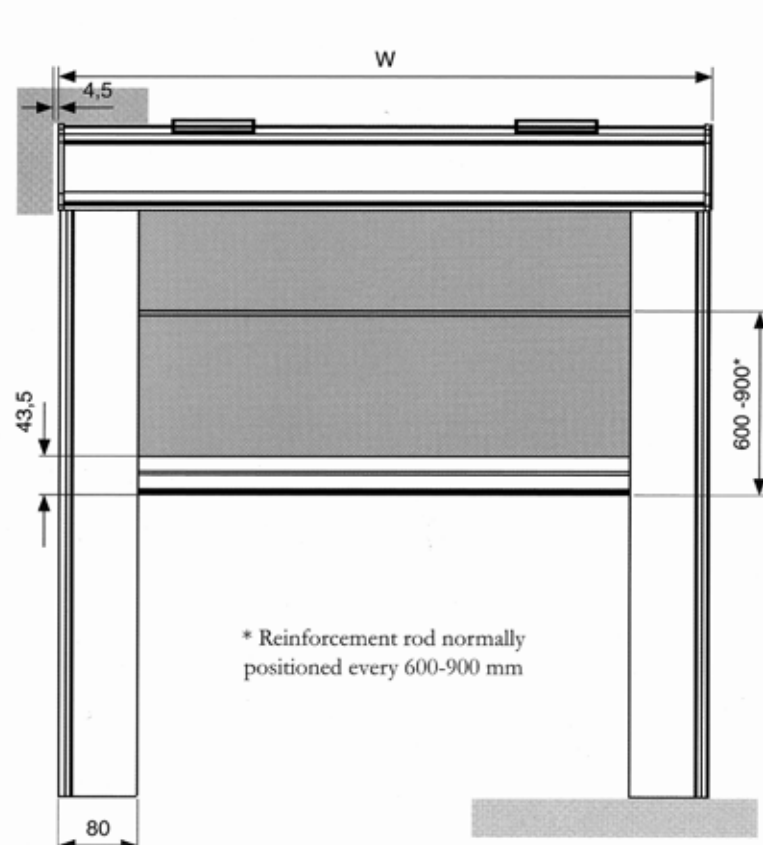

MOUNTING OPTIONS FOR HORIZONTAL MODEL



Standard

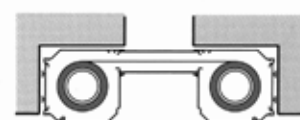

Reverse

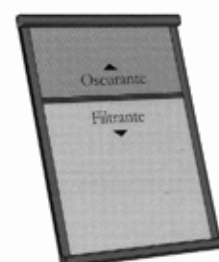

Possibility of twin fabric upon request

Rua Mestre Sidónio 9A, 9020 - 365 Funchal, Madeira, PORTUGAL (junto ao hiper Continente / Viveiros)
Telefone: 291 741 884 | Telemóvel: 96 50 10 699 | E-mail: info@lismarca.pt

WWW.LISMARCA.PT